

Infrared urinal flush valve SLP 02KX including frame SLR 22 SLP 03KX



Characteristics



- includes Bluetooth control
(paid Sanela control app available for download)
- including mounting frame SLR 22
- frame designed for plasterboard structures, for anchoring to the floor and to the rear wall
- metal frame structure with blue surface finish powder coating
- mounting screws M10 and M8, waste holder with elbow Ø 50 mm and water inlet G 1/2"
- responds to the presence of a person in front of the urinal at a distance max 0.7 m from the sensor for longer than 7.5 s
- flushing occurs after the person leaves the detected zone
- flush time is adjustable from 0.5 to 15.5 s
- parameter settings and communication with the electronics via Sanela control app (Bluetooth) or the SLD 03
- automatic flushing 24 hours after the last valve activation
- possibility to regulate water flow with a ball valve
- brushed finish

Building preparation

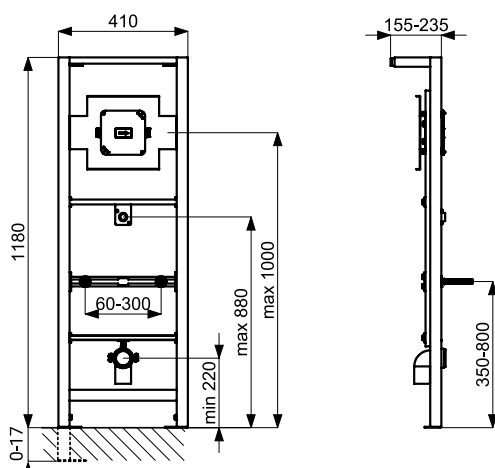

- 1 - water supply
- 2 - stainless steel cover with electronics
- 3 - plastic mounting box with ball and solenoid valve
- 4 - sensing area
- 5 - outlet to urinal
- 6 - power supply 24 V DC
- 7 - urinal
- 8 - siphon
- 9 - mounting frame SLR 22

Technical Specification

Stainless steel cover dimensions	170 x 170 x 10 mm
Mounting box dimensions	140 x 140 x 75 mm
Frame dimensions	1120 - 1290 x 410 x 155 - 235 mm
Supply voltage	24 V DC
Power input	7 W
Range	0,6 - 0,75 m
Recommended working pressure	0.1 - 0.6 MPa
Flow rate	18 l/min (informative value)
Water inlet	external thread G 3/4"
Water outlet	outlet fitting with gasket

Supply specification

SLP 03KX - Supply No. 11030

stainless steel cover with electronics including Bluetooth module, plastic mounting box with fittings, solenoid valve and ball valve, flexible connecting hose, outlet fitting with a rubber seal, mounting frame SLR 22

Recommended accessories

SLZ 01Y	- Supply No. 05012	power supply 24 V DC for max. 5 flushers
SLZ 01Z	- Supply No. 05011	power supply 24 V DC for max. 9 flushers
SLZ 04Y	- Supply No. 05042	power supply 24 V DC for DIN rail, for max. 5 flushers
SLZ 04Z	- Supply No. 05041	power supply 24 V DC for DIN rail, for max. 9 flushers
SLZ 04X	- Supply No. 10049	power supply 24 V DC for DIN rail, for max. 15 flushers
SLD 03	- Supply No. 07030	remote control for an adjustment of parameters
SANELA CONTROL APP		paid Sanela Control app available for download on the App Store and Google Play